

**Installation Instructions for the Accent/Euro  
Collection Sliding Enclosure with 90° Side Panel.  
Model: ATE-ASE & UTE-USE-90  
Drawing Number: 6149      Rev. Date: 09-04-07**

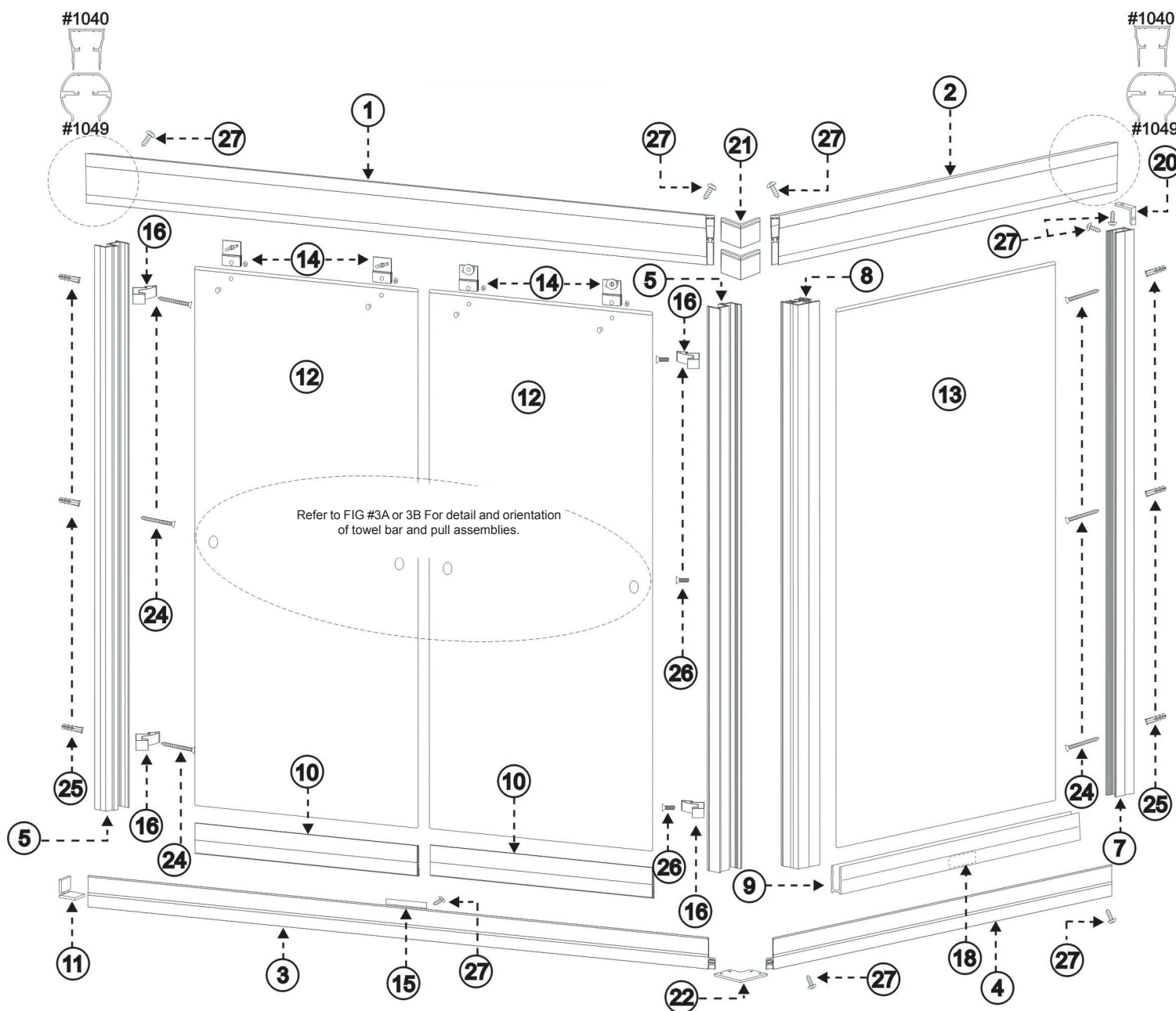

**Figure #1 - ATE-ASE & UTE-USE 90 Shower Door Assembly**



**Installation Instructions for the Accent/Euro  
Collection Sliding Enclosure with 90° Side Panel.  
Model: ATE-ASE & UTE-USE-90  
Drawing Number: 6149 Rev. Date: 09-04-07**



**Figure # 2 - Shower Door Assembly - Side View**

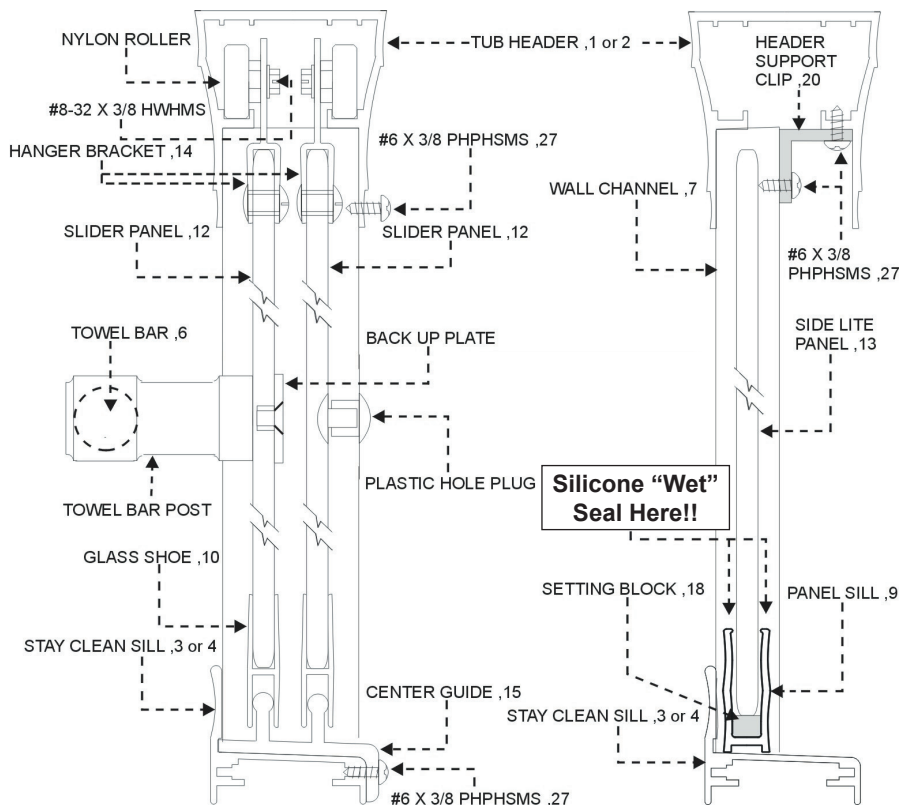

**Figure # 3a - Shower Door Assembly - Top View**

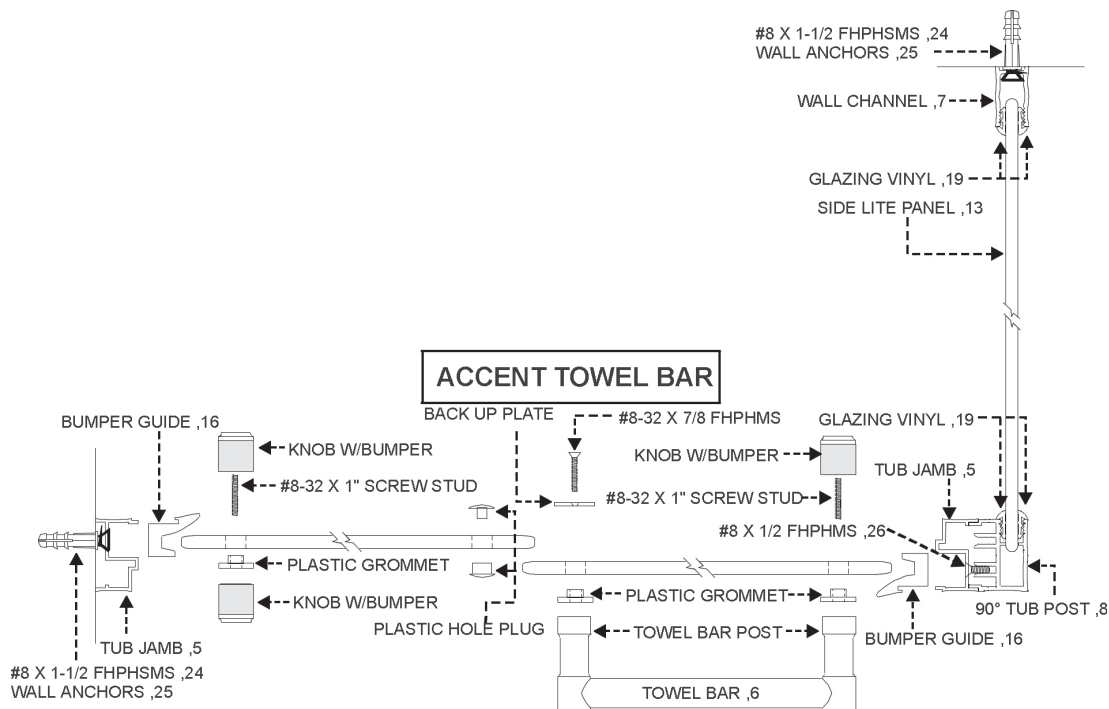

**Installation Instructions for the Accent/Euro  
Collection Sliding Enclosure with 90° Side Panel.  
Model: ATE-ASE & UTE-USE-90  
Drawing Number: 6149 Rev. Date: 09-04-07**



**Figure # 3b - Euro Towel Bar**  
(Instructions in Towel Bar package)

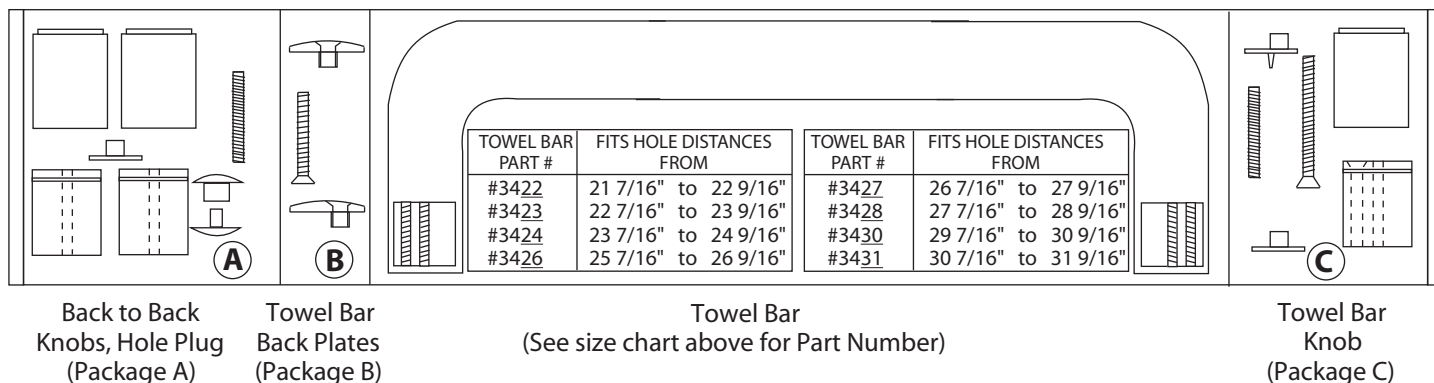

**Figure # 4**

**Figure # 5**

**Figure # 6**

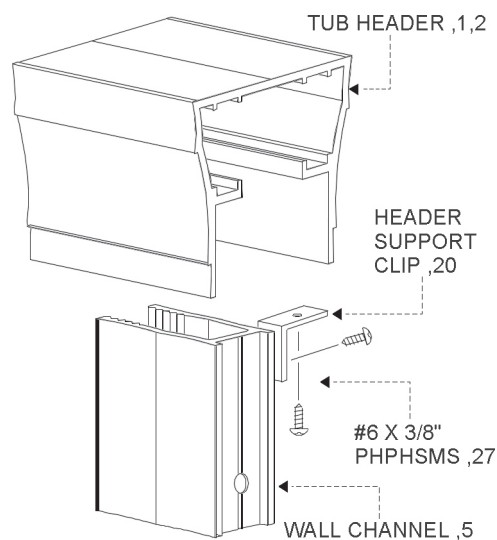
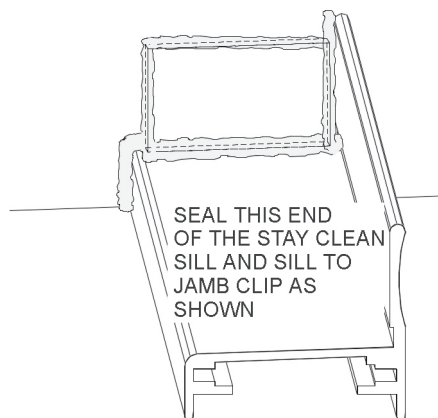
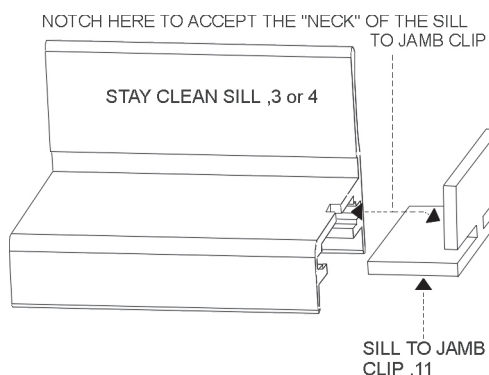

**FIG. #7 - Top View - Looking down at the sill with panel installed in header.**

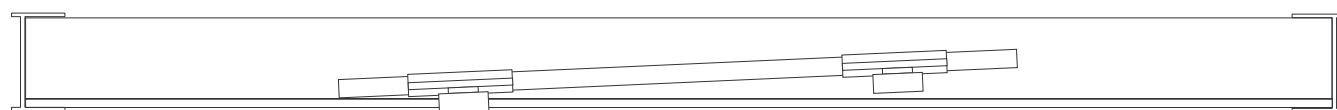
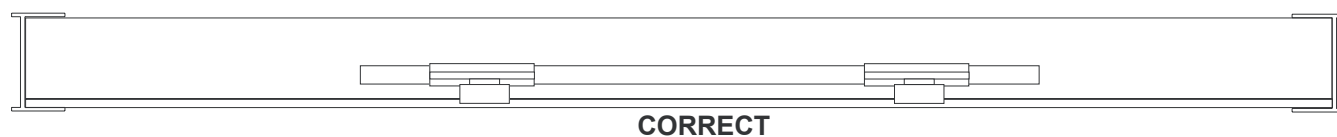

**Installation Instructions for the Accent/Euro  
Collection Sliding Enclosure with 90° Side Panel.  
Model: ATE-ASE & UTE-USE-90  
Drawing Number: 6149 Rev. Date: 09-04-07**



## 6149 - ATE-ASE & UTE-USE 90 Parts List

ITEM #	PART #	DESCRIPTION	QTY	ITEM #	PART #	DESCRIPTION	QTY
1	1040/1049	TUB HEADER LEFT SECT.	1	14	2108	#8-32 X 3/8 HWH SCREW	4
2	1040/1049	TUB HEADER RIGHT SECT.	1	14	2212	FEMALE FASTENER	4
3	1120	STAY CLEAN SILL LEFT SECT.	1	14	2109	#6-32 X 5/16 TRUSS SCREW	4
4	1120	STAY CLEAN SILL RIGHT SECT.	1	15	2205	CENTER GUIDE	1
5	1042	TUB JAMB	2	16	2208	BUMPER GUIDE	4
6	1200/3010	TOWEL BAR	1	17	2215	ADJUSTMENT WRENCH	1
7	1026	WALL CHANNEL	1	18	2203	SETTING BLOCK	1
8	1004	90° POST	1	19	4013	VS-3 GLAZING VINYL	4
9	1016	PANEL SILL	1	20	2019	HEADER SUPPORT CLIP	1
10	1121	GLASS SHOE	2	21	2013	90° TUB HEADER CLIP	4
11	2008	SILL TO JAMB CLIP	2	22	2006	90° STAY CLEAN SILL PLATE	1
12	7002	SLIDING GLASS PANEL	2	23	2216	5/64' ALLEN WRENCH	1
13	7006	SIDE LITE GLASS PANEL	1	24	2101	#8 X 1-1/2 FHPHMS	6
14	2256	HANGER BRACKET ASSY	4	25	2217	3/16" WALL ANCHOR	6
14	2214	3/4" NYLON ROLLER	4	26	2106	#8-32 X 1/2 FHPHMS	3
				27	2102	#6 X 3/8 PHPHMS	5

## 6149 - ATE-ASE & UTE-USE 90 Assembly Instructions



### SAFETY WARNING:

These installation instructions must be followed to ensure proper operation of the door and to reduce the risk of serious injury. Any deviation from these instructions can result in a serious safety hazard.

All exposed ends of aluminum that are rough, sharp or jagged due to the metal being cut, drilled or damaged should be deburred, smoothed or rounded by the installer before installation. Failure to do so could result in serious injury to the user of the enclosure.

Any part of the swinging glass panels hitting any unprotected bathroom obstruction or metal or glass component of the shower door itself, may indicate improper installation and could lead to serious injury. Installers must correct the deficiencies before allowing the door to be used.



### SPECIAL NOTE:

Drilling holes and anchoring horizontal sills and curbs to thresholds and tub decks is discouraged. Using masking tape or double-sided tape to hold these components down during installation is recommended to minimize the potential for water leaking underneath flooring. These instructions do not recommend drilling holes on horizontal surfaces for this reason.

### STEP 1 - STAY CLEAN SILL:

On the shower base, mark the centerline of the unit. Measure each centerline distance. Add 13/16" to each measurement and transfer to the appropriate sill sections (Item #3 & 4). NOTE: All dimensions on the sill and header are measured from the tip, (farthest point), of the 45° miter. Be sure to select the sill that is mitered in the direction for the side that you are measuring. At this time, cut only the sill sections to their installed lengths. Straight cut the butt ends opposite the miter to achieve the finished length. NOTE: it may be

**Installation Instructions for the Accent/Euro  
Collection Sliding Enclosure with 90° Side Panel.  
Model: ATE-ASE & UTE-USE-90  
Drawing Number: 6149      Rev. Date: 09-04-07**



necessary to file a radius on the ends of the Stay Clean Sill to fit snugly against the wall. The Stay Clean Sill must now be notched to accept the Sill to Jamb Clip to help lock the Sill into place. Take the Sill to Jamb Clip (Item #11) and slide it into the end opposite the miter of the Stay Clean Sill that will be on the slider side. Be sure that the clip is positioned (as shown in Fig. #4) with 1/8" x 1/8" "neck" portion of the clip pointing up. Using the clip as a template, mark the neck of the clip onto the sill. Use a standard 1/8" thick medium file to cut a notch that is at least 1/8" deep. This will allow the clip to be flush with the end of the sill. The Sill to Jamb Key is only required at the end of the sill that will be under the sliding panels. Position the Center Guide (Item #15) onto the Stay Clean Sill where the sliding panels will go. Measure the width of one Sliding Glass Panel (Item #12). Mark this dimension onto the sill measuring off the notched end of the sill. Set the Center Guide into place and, using the factory hole as template, drill through the hole into the sill with an #32 wire gauge drill bit. NOTE: Do not attach the Center Guide at this time. Assemble the right and left sill sections by sliding the 90° Stay Clean Sill Plate (Item #22) into the slot on the under side of each sill. Hold the miters tightly together and tighten the set screws on the plate using the 5/64" Allen Wrench (Item #23) provided in the parts kit. With the Sill to Jamb Clip in place, set the Stay Clean Sill back onto the tub rim or shower sill. Use a pencil or non-permanent marker to mark the location of the Stay Clean Sill on the tub rim at each point where it meets each wall so that the sill can be repositioned later. Use masking tape to hold the sill in place while proceeding. Apply sealant only to the end of the Stay Clean Sill with the notch at this time. Please refer to Fig. #5 for sealant location.

**STEP 2 - TUB JAMB:**

Place one of the Tub Jambs (Item #5) against the wall at the end of the Stay Clean Sill with the notch and clip. IMPORTANT NOTE: The INSIDE sliding panel, when closed, must be the closest panel to the shower head wall. The OUTSIDE panel, when closed, must be away from the shower head wall. The Tub Jamb can be rotated to accept either an inside or an outside panel. Please refer to Fig. #3A for proper orientation. The lower end of the Tub Jamb should rest on the horizontal surface of the Stay Clean Sill and over the vertical leg of the 90° Sill to Jamb Clip. Using a level, plumb the Tub Jamb. Be careful not to disturb the caulking at the end of the Stay Clean Sill. With the jamb plumb, mark all three factory hole locations onto the wall using the Tub Jamb as a template. Carefully remove the Tub Jamb and drill the three holes using a 3/16" drill bit (use a carbide tipped bit if going into tile or other types of masonry materials). Take care that no debris gets into the caulk as you drill. Insert three Wall Anchors (Item #25) into the holes. Replace the Tub Jamb and realign. Position one Bumper Guide (Item #16) over the top and bottom holes and secure the Tub Jamb with three #8 X 1-1/2" FHPSMS (Item #24).

**STEP 3 - WALL CHANNEL:**

Ensure that the Stay Clean Sill is still properly aligned and secured with masking tape. Set the Wall Channel (Item #7) in place on the horizontal surface of the Stay Clean Sill, at the wall opposite the Tub Jamb, up against the vertical edge of the sill with the open edge of channel facing away from wall. Refer to Fig. #3A. Plumb the wall channel with a level. Using the wall channel's pre-drilled holes as a template, mark the three installation holes on the wall. Remove wall channel and drill holes into the wall with a 3/16" drill bit (use carbide tipped bit if going into tile or other types of masonry material). Insert one Wall Anchor (Item #25) into each hole. Reposition the wall channel, align the holes, and secure with three #8 x 1-1/2" FHPSMS (Item #24). Take the Header Support Clip (Item #20) and position it flush to the top of, and on the inside of the wall channel. The "L" shape of the clip will point vertically down the wall channel and horizontally away from the channel, toward the inside of the shower. It should be indexed an 1/8" off the wall. See Fig. #6. Using the clip as a template, mark the factory hole location onto the wall channel. Drill the hole with an 1/8" drill bit, then secure with one #6 X 3/8" PHPSMS (Item #27).

**STEP 4 - SIDELITE PANEL:**

Take the second Tub Jamb, (Item #5), and orient it so that the channel that has the three countersunk holes in it is positioned to the outside of the shower. Attach the Tub Jamb to the 90° post by flushing both ends then secure them with three #8-32 X 1/2" FHPSMS, (Item #26), installing a Bumper Guide, (Item #16), with the top and bottom screws. See Fig. #1. CAUTION: Do not over tighten the screws. Measure the width of the Side Lite Panel and add 1" to the measurement. Cut the Panel Sill, (Item #9), to this dimension. Insert the Setting Block, (Item #18) into the Panel Sill. Set the Panel Sill in place on the Stay Clean Sill and slide it into the Wall Channel. Set the Side Lite Panel into the Panel sill and slide the glass into the Wall Channel. Use masking tape to temporarily keep the Panel sill from sliding off the Stay Clean Sill. Hold the glass panel in place by glazing the top of the panel with a few inches of VS-3 Glazing vinyl, (Item #19). NOTE: Do not cut the vinyl at this time. Position the post combination in place on the Stay Clean Sill and over the edge of the glass panel. Temporarily hold post in place by glazing the top of the post with VS-13 Glazing Vinyl. NOTE: Do not cut the vinyl at this time. Attach the bottom of the post to the Stay Clean Sill by drilling through the return panel Stay Clean Sill into the 90° Post with a #32 wire gauge drill bit. Be careful not to drill or screw into the glass panel. The panel can be moved from side to side while drilling. Secure with one #6 X 3/8" PHPSMS (Item #27).



**Installation Instructions for the Accent/Euro  
Collection Sliding Enclosure with 90° Side Panel.  
Model: ATE-ASE & UTE-USE-90  
Drawing Number: 6149      Rev. Date: 09-04-07**



**STEP 5 - TUB HEADER:**

Using a level, plumb the 90° post in both directions. With the post plumb, measure from the outside corner of the post to the wall. Add 5/16" to this measurement for the 1040 header and 11/16" for 1049 header. Mark this dimension on a header section (Item #1 or #2). NOTE: All dimensions on the header and sill are measured from the tip, (the farthest point) of the 45° miter. Be sure to select the header that is mitered in the right direction for the side that you are measuring. At this time, cut the header to length by cutting the butt end opposite the miter to achieve the finished length. Repeat this procedure for the second header section. Assemble the right and left header sections with four 90° Tub Header Clips (Item #21). See Fig. #1. Set headers in place over the vertical posts and Header Support Clip. Be sure that the roller channels of the header are resting firmly on the verticals. Secure the header assembly to the vertical posts from the inside of the shower by drilling through the headers into the Tub Jamb and 90° Post with a #32 wire gauge drill bit. Using the same bit, attach the header to the Wall Channel as shown in Fig. #6. Be careful not to drill or screw into the glass panel. The panel can be moved side to side while drilling. Secure the headers with three #6 X 3/8" PHPHSM screws (Item #27).

Center the Side Lite Panel between the posts and glaze with four pieces of VS-3 glazing vinyl, (Item #19) for the verticals and "wet" seal the bottom horizontal Panel Sill with sealant. See Fig. #2. NOTE: The vinyl seals are designed to be tight to provide maximum water protection and minimize shrinkage due to temperature extremes. If it becomes difficult to push the vinyl in place, lubricate it with glass cleaner. This will allow easy installation then will evaporate leaving the vinyl tight and smooth. Do not use any type of grease, oils, or silicone sprays as these will harm the vinyl and will stay in place long after the installation is complete compromising safety as well as water protection.

**STEP 6 - Sliding Panels:**

Carefully set the inside panel into the shower area on a protective pad, ensuring that it can not fall. From the outside of the shower hang the outside Sliding Glass Panel in place in the header. Be sure that the roller are securely in the roller channel of the header. From the inside of the shower, hang the inside Sliding Glass Panel in place making sure that the rollers are securely in the roller channel of the header. With both panels in place, slide both panels to one side. Slide the Center Guide, (Item #15), into each Shoe assembly and align it with the hole drilled in Step 1. Secure with one #6 X 3/8 PHPHSMs, (Item #27). See Fig. #2.

**STEP 7 -Towel Bar and Pulls:**

**Accent Towel Bar (Fig. #3A):**

On the outside Sliding Glass Panel, measure center to center between the towel bar holes. Cut the Towel Bar, (Item #6) to this length. For the pull assemblies, slide the glass panels to their proper close position. You will notice the two center holes are inaccessible because of the overlap in the panels. Slide each glass panel to the opposite wall. Now the holes are at the outside edges. Begin installation by inserting the male and female clear plastic hole plugs on the outside hole of the inside panel. Place one hole grommet followed by the backup plate and one #8-32 X 7/8 FHPPHMS into the outside hole of the outside panel. Thread screw into one towel bar post on outside of glass panel. Slide both glass panels back to their proper closed position and refer to Fig. #3A for the rest of the installation. WARNING: This shower door must not be installed without the hole grommets. The grommets prevent the glass from touching the metal screw. If the screw touches the glass, the glass can break and create a serious safety hazard. If it is necessary to allow the glass panels to totally bypass each other, contact your Agalite Representative and ask for Part # 3013 in the appropriate color.

**Euro Towel Bar (Fig. #3B):**

Please refer to installation instructions in the Towel Bar package.

**STEP 8 - Sliding Panel Adjustment:**

If either panel is skewed, or rubs against the sill, adjust the panels by loosening the hex nut on any of the Hanger Brackets with the Adjustment Wrench, (Item #17), provided in the parts kit, and compensate the panels for the wall conditions. NOTE: The panels do not need to be removed from the header to adjust.

**STEP 9 - Sealant:**

Apply a bead of sealant along the entire inside of the enclosure where it meets the wall and base.