

Installation Instructions for the Accent/Euro
Collection Swing Door With In-line Panel.

Model: ASD-180/280 & USD-180 /280 Rev. Date: 04-06-06

Drawing #: 6141



FIG. #1 - ASD & USD 180/280 Shower Door Assembly

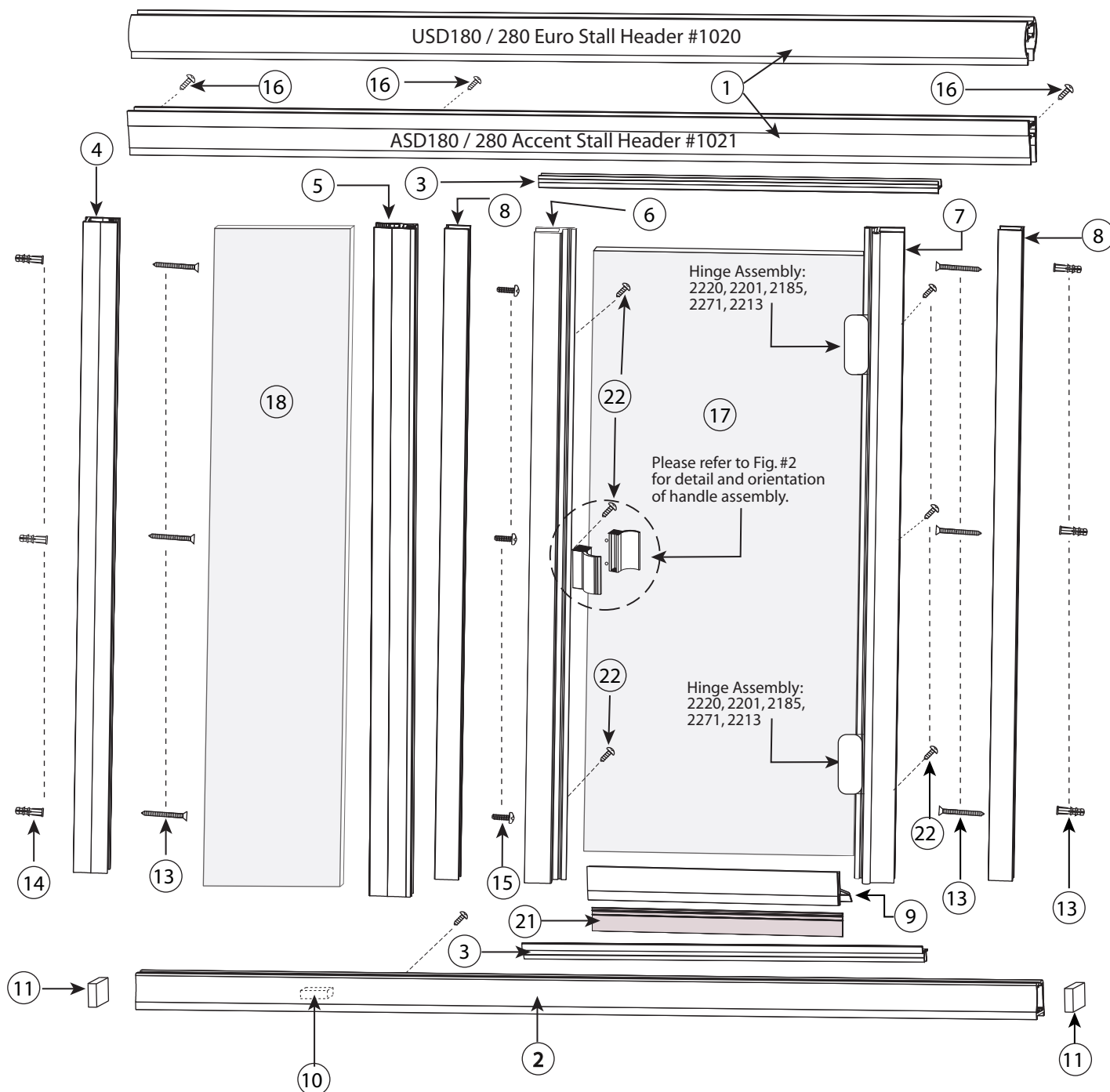

Installation Instructions for the Accent/Euro Collection Swing Door With In-line Panel.

Model: ASD-180/280 & USD-180 /280 Rev. Date: 04-06-06

Drawing #: 6141



FIG # 2 - Shower Door Side View

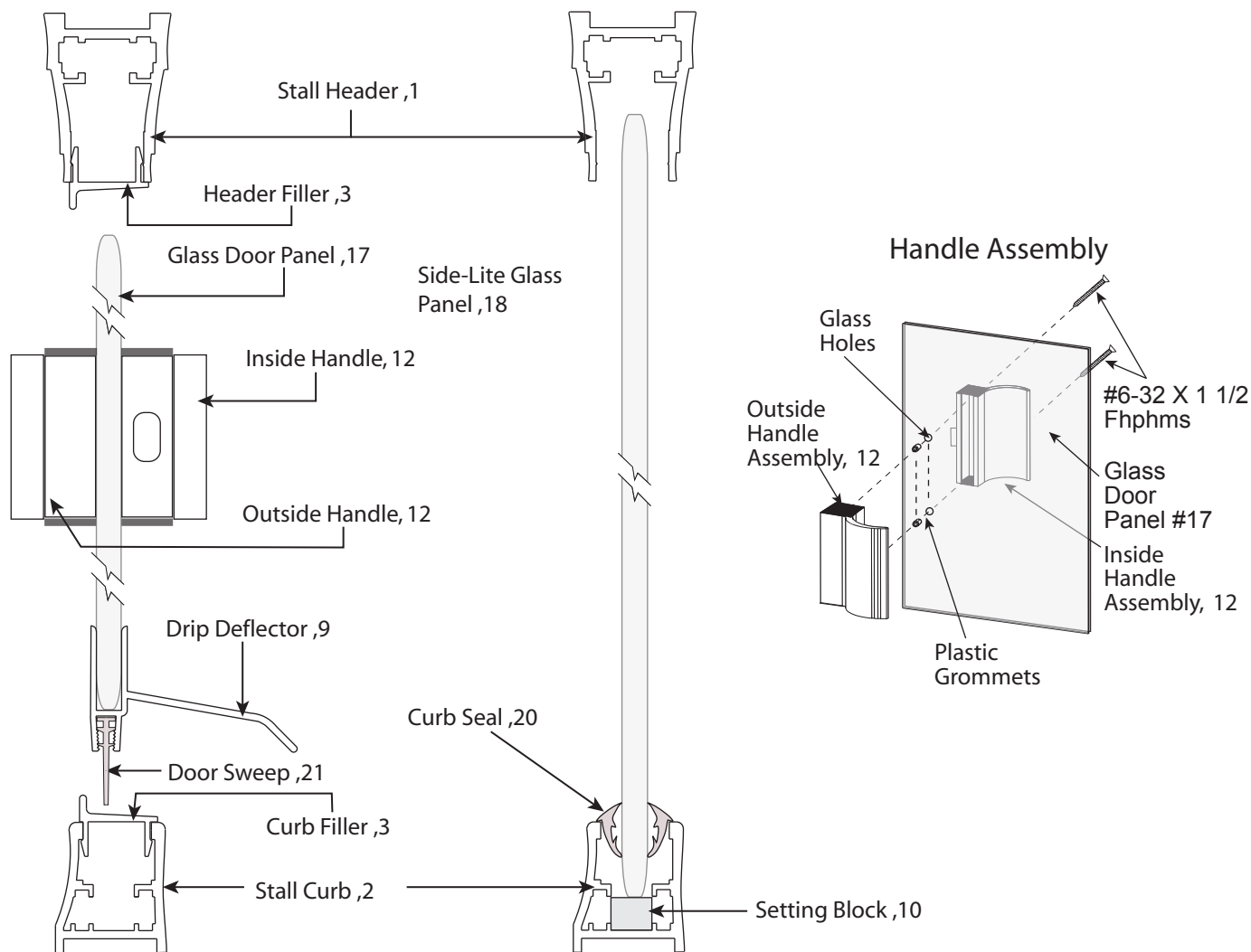
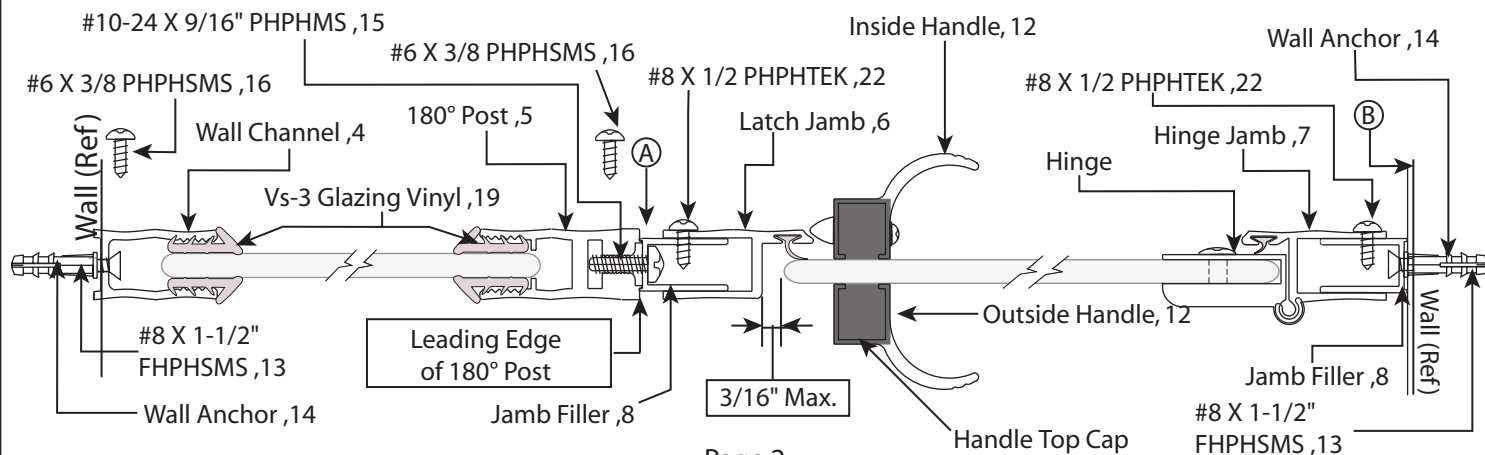

FIG. #3 - Shower Door Assembly - Top View



Installation Instructions for the Accent/Euro Collection Swing Door With In-line Panel.

Model: ASD-180/280 & USD-180 /280 Rev. Date: 04-06-06

Drawing #: 6141



Fig. #4 - Stall Curb Filler

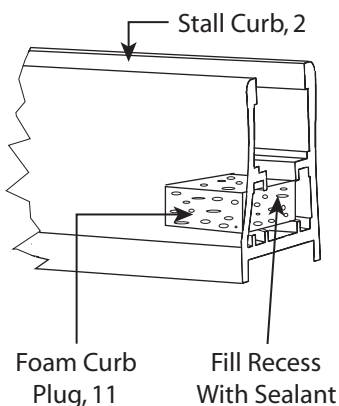

Fig. #5 - Notching

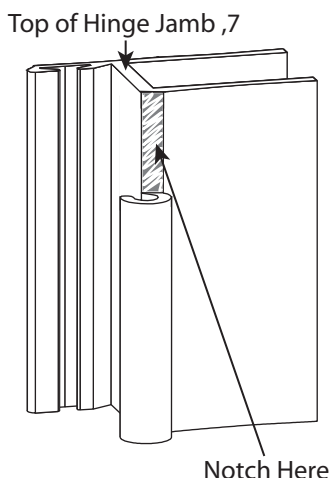

Fig. #6 Jamb Filler

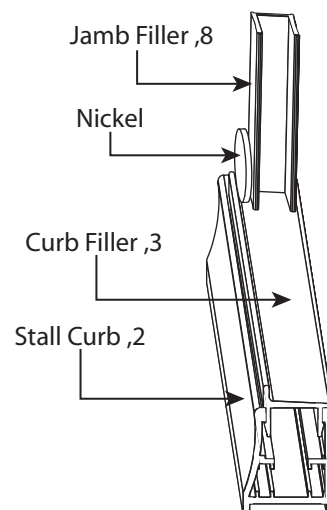
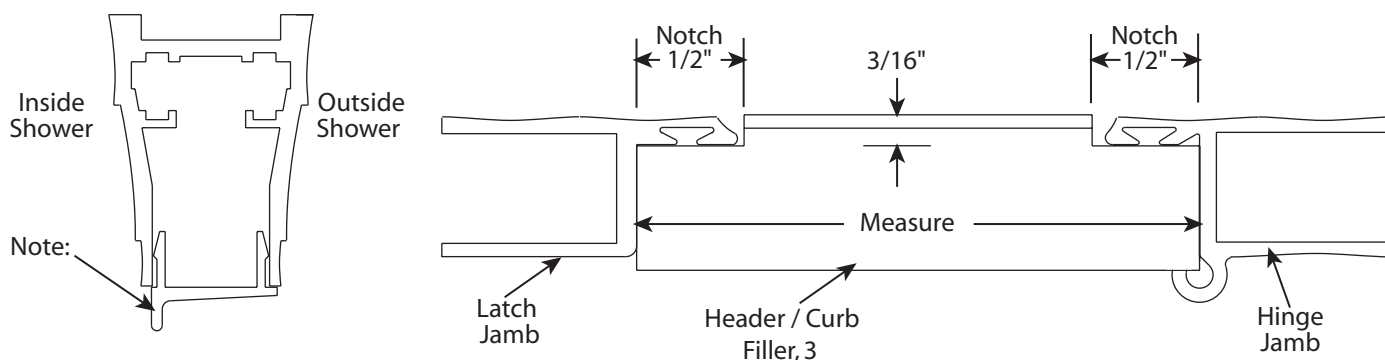

Fig. #7 Header Filler #1025 Measurements



6141 - ASD & USD 180/280 Parts List

ITEM#	PART#	DESCRIPTION	QTY.	ITEM#	PART#	DESCRIPTION	QTY.
1	1020/1021	Stall Header	1	8	1003	Jamb Filler	2
2	1022	Stall Curb	1	9	1009	Drip Deflector	1
3	1025	Header/Curb Filler	2	10	2203	Setting Block	1
4	1026	Wall Channel (ASD280: 2 ea)	1	11	2204	Foam Curb Plug	2
5	1031	180° Post (ASD280: 2 ea)	1	12	Fig. #2	Handle Assembly	1
6	1001	Latch Jamb	1	13	2101	#8 X 1-1/2 FHPHMS	6
	4015	Latch Jamb Vinyl	1	14	2217	3/16 Wall Anchors	6
7 Hinge Jamb Assembly	1002	Hinge Jamb	1	15	2111	#10-24 X 9/16 PHPHMS	6
	4015	Hinge Jamb Vinyl	1	16	2102	#6 X 3/8 PHPHMS	8
	2220	Hinge	2	17	7004	Glass Door Panel	1
	2201	Hinge Pin	2	18	7006	Side-Lite Panel (ASD280: 2 ea)	1
	2185	#8-32 X 7/16 Truss Head	2	19	4013	VS-3 Glazing Vinyl (ASD280: 8 ea)	4
	2271	3/16 Grommet	2	20	4011	VS-1 Curb Seal	1
	2213	Hinge Bushings	4	21	4018	VW-2 Bottom Sweep	1
				22	2110	#8 X 1/2 PHPH TEK	6

Installation Instructions for the Accent/Euro

Collection Swing Door With In-line Panel.

Model: ASD-180/280 & USD-180 /280 Rev. Date: 04-06-06

Drawing #: 6141



6141 - ASD & USD 180/280 Assembly Instructions

These installation instructions must be followed to ensure proper operation of the door and to reduce the risk of serious injury. Any deviation from these instructions can result in a serious safety hazard.

All exposed ends of aluminum that are rough, sharp or jagged due to the metal being cut, drilled or damaged should be de-burred, smoothed or rounded by the installer before installation. Failure to do so could result in serious injury to the user of the enclosure.

Any part of the swinging glass panels hitting any unprotected bathroom obstruction or metal or glass component of the shower door itself, may indicate improper installation and could lead to serious injury. Installers must correct the deficiencies before allowing the door to be used.



SPECIAL NOTE:

Drilling holes and anchoring horizontal sills and curbs to thresholds and tub decks is discouraged and is left to your discretion. Using masking tape or double-sided tapes to hold these components down during installation is recommended to minimize the potential for water leaking underneath flooring and onto ceilings below. These instructions do not recommend drilling holes on horizontal surfaces for this reason. Deviating from recommended installation instructions voids the Agalite Lifetime Warranty.

The Agalite Model AS-280 is installed in the same way as Model AS-180 with a few minor modifications. These instructions will guide you through the installation of the the model AS-180, but will make special notations where the necessary modifications for the AS-280 are made. Please be aware of these deviations.

STEP 1 - STALL CURB:

On the centerline of the tub or shower sill, measure the wall to wall net opening, 1/2" above the sill. From this measurement deduct 1/16" and cut stall curb (ITEM #2) to length. NOTE: Your curb section may already be cut to size from the factory. Set curb section in place over centerline and mark curb location at each wall. NOTE: Ensure weep holes are oriented to the inside of the shower. Insert one Foam Curb Plug (ITEM #11) into each end of stall curb, recessing them approximately 1/8". Refer to FIGURE #4. Fill each recess with sealant and position the stall curb over the centerline and temporarily hold in place with strips of masking tape. Insert one Setting Block (ITEM #10) into the stall curb where the side-lite panel will set. With a screwdriver, push each Foam Curb Plug into each wall to seal the curb ends.

STEP 2 - WALL CHANNEL:

Center the Wall Channel (ITEM #4) on the Side-Lite Panel side of the Stall Curb and against the wall with open edge of channel facing away from wall. Refer to FIGURE #3. Plumb the wall channel, then using the wall channel's pre-drilled holes as a template, mark the three installation holes on the wall. Remove wall channels and drill holes into the wall with a 3/16" drill bit. (Use carbide tipped bit if going into tile or other types of masonry material). Insert three wall anchors (ITEM #14). Reposition the wall channel, align the holes, and secure with 3- #8 x 1-1/2" FHPSMS, (ITEM #13).

AS-280: Repeat above step with second Wall Channel at opposite wall.

STEP 3 - SIDE-LITE PANEL:

Insert the Side-Lite Glass Panel (ITEM #18) into the curb and slide into the wall channel. NOTE: If obscure, frosted or pebbled glass is used, ensure that the rough side of the panel faces to the outside. Insert the 180° post into the curb and over the edge of the glass panel. Adjust door opening by first noting what size door you have been supplied with your unit. It will be marked on the front of the door carton with a designation of ASD - then a door size. (EXAMPLE: ASD - 24). Take your door size and add 1/4" to it. This is the minimum dimension that you must have between the leading edge of the 180° post and the wall. Please note reference points A and B in FIGURE #3. Move the bottom of the 180° Post to this position. With a level, plumb the 180° Post and temporarily hold the post in place by glazing the top of the post with a few inches of the VS-3 Glazing Vinyl (ITEM #19). (NOTE: Do not cut the glazing vinyl at this time). At this point, it is necessary to determine if the Side-Lite Glass Panel is far enough into both vertical posts for proper glazing. 1/4" is the minimum penetration into each post. If this minimum penetration is not met, the 180° Post must be moved further onto the Side-Lite Glass panel to achieve the necessary coverage. The door assembly will cover any discrepancy.

AS-280: Repeat above procedure for second Side-Lite Glass Panel and the 180° Post. Reference points A and B will be between the leading edges of the two 180° Posts instead of the 180° Post and the wall.

Installation Instructions for the Accent/Euro Collection Swing Door With In-line Panel.

Model: ASD-180/280 & USD-180 /280 Rev. Date: 04-06-06

Drawing #: 6141



6141 - ASD & USD 180/280 Assembly Instructions Cont.

STEP 4 - CURB FILLER:

Measure between the leading edge of the 180° Post and the wall and cut the Curb Filler (ITEM #3) to this dimension. Please refer to reference points A and B in FIGURE #3. With the Curb Filler water dam to the outside of the shower, firmly snap filler into place between the 180° Post and the wall. Refer to FIGURE #2 for proper orientation. The door assembly will be installed on top of the Curb Filler. Install one Jamb Filler (ITEM #8) at the wall opposite the Wall Channel. This jamb will support either the Hinge Jamb or the Latch Jamb, depending on your requirements. Start by setting the Jamb Filler on top of the Curb Filler with the open edge of the channel facing away from the wall. Use an ordinary nickel (5¢) to space the bottom of the Jamb Filler back from the vertical water dam on the Curb Filler. Refer to FIGURE #6. This is necessary to allow clearance for either the Hinge Jamb or the Latch Jamb later on. With the bottom properly spaced, use a level and plumb the Jamb Filler. Use the factory holes as a template and mark the hole locations onto the wall. Remove the filler and drill the holes using a 3/16" drill bit. Insert 3- Wall Anchors (ITEM #14) into the holes. Realign the filler with the holes and secure with 3- #8 X 1-1/2" FHPHMS (ITEM #13).

AS-280: The measurement taken for the Curb Filler will be between the leading edges of the two 180° Posts with the Curb Filler being snapped in between them as well. Disregard the text that instructs you to attach the Jamb Filler to the wall.

STEP 5 - STALL HEADER:

Measure wall to wall at the top of the vertical posts. Subtract 1/16" and cut the Stall Header (ITEM # 1) to this length. Set header in place over the top of all the verticals. Verify that the 180° post has not moved from your A to B dimension at the curb, then tap the top of the post into place. Use a level to make sure that post is plumb. From the inside of the shower, attach the header to the top of the Wall Channel and the 180° post only by drilling through the header into the vertical posts with a #32 wire gauge drill bit and securing with 2- #6 x 3/8" PHPHMS (ITEM #16). The Header over the Jamb Filler must be left unsecured at this time. Be very careful not to drill or screw into the glass panel. The panel can be moved side to side while drilling. After attachment is complete, center the side-lite panel between the posts and glaze with 4 pcs. of VS-3 vinyl (ITEM #19). NOTE: The vinyl seals are designed to be tight to provide maximum water protection, and minimize shrinkage due to temperature extremes. If it becomes difficult to push the vinyl in place, lubricate it with glass cleaner. This will allow easy installation then will evaporate leaving the vinyl tight and smooth. SPECIAL NOTE: Do not use any type of grease, oils, or silicone sprays as these will harm the vinyl and compromise safety as well as water protection. Finish this step by installing the remaining Jamb Filler(s) to the 180° Post(s) as follows: Position the closed edge of the Jamb Filler(s) to the 180° Post(s) as shown in (FIG. #3), with the bottom of the Jamb Filler(s) setting on top of the Curb filler. Secure the Jamb Filler(s) to the 180° Post(s) with 3- #10-24 X 9/16" PHPHMS (ITEM #15).

AS-280: Notice that both Jamb Fillers should be in position at this time.

STEP 6 - DRIP DEFLECTOR:

Take the Door Bottom Sweep (ITEM #21) and slide it into the bottom of the Drip Deflector as shown in FIGURE #5. A mild solution of soapy water will help if the sweep is difficult to pull through. The vinyl sweep has a memory when it is stretched, so be sure to work the sweep back and forth after it is drawn into the deflector. Trim the vinyl leaving 1/4" of the Door Sweep protruding from each end. Set the door assembly on its top on a cushion or pad, so that the bottom of the door is up. Set the Drip Deflector (ITEM #9) over the bottom edge of the door with the deflector portion to the inside of the shower. With a mallet or block of wood, gently tap the deflector over the edge of the door panel as far as it will go. In most cases, the glass thickness is enough to hold the Drip Deflector in place for the life of the door. In some circumstances the glass may be slightly thinner, depending on the type of glass being used, or the manufacturer of the glass its self. In these cases, the corners of the Deflector may be pinched to hold the Deflector in place, or simply inject a small amount of caulking into the channel where the glass will fit to maximize the holding power of the Deflector. NOTE: Only a small amount of caulking is necessary, too much caulking will be squeezed out during adjustment. It will be readjusted later. Make sure that the Drip Deflector does not protrude past the edge of the glass on the handle side. Debur and round the exposed ends of the drip deflector.

STEP 7 - DOOR ASSEMBLY:

Measure from the top horizontal surface of the Curb Filler, (the surface that the Jamb Fillers are setting on), to the bottom of the header.

Installation Instructions for the Accent/Euro

Collection Swing Door With In-line Panel.

Model: ASD-180/280 & USD-180 /280 Rev. Date: 04-06-06

Drawing #: 6141



6141 - ASD & USD 180/280 Assembly Instructions Cont.

STEP 7 - DOOR ASSEMBLY Cont:

Then transfer the measurement to the jamb and make a mark on the Hinge Jamb Barrel. Using a hacksaw, notch the Hinge Barrel that is at the top of the hinge jamb down to the mark you made. This procedure can be performed while still attached to the glass panel. Refer to FIGURE #5 before cutting the Hinge Jamb Barrel.

The ASDJ door is designed to adjust upward in width from a tight position a total of 1". EXAMPLE: An ASDJ-24 door will fit a net opening of 24" tight up to 25" totally expanded out. The net opening for this model is the dimension between the leading edge of the 180° Post and the wall (the same dimension that the Curb Filler was cut to). Adjustment should be made by adjusting the Hinge Jamb first, then the Latch Jamb, equally off both Jamb Fillers. Slide the door assembly over the appropriate Jamb Filler and move it to the determined dimension off the wall or 180° Post. Use a small level placed along the top horizontal edge of the glass to level the door. From the inside of the shower, drill through the top pilot hole in the Hinge Jamb into the Jamb Filler using a #32 wire gauge drill bit. Secure the top hole with one #8 X 1/2" PHPHMS (ITEM #16). The door will hold in place with only the top screw installed. Next, re-level the door and drill through the middle and bottom holes with a #32 wire gauge drill bit then secure with two #8 X 1/2" PHPHMS (ITEM #16).

AS-280: Net door opening is between the two 180° Posts instead the post and the wall. The length of the Curb Filler still represents the net door opening.

STEP 8 - LATCH JAMB:

Slide the Latch Jamb in place over the appropriate Jamb and up into the header. Do not secure the Latch Jamb at this time. Move the door to the closed position, pulling the Latch Jamb off enough so that it stops the door. With the door closed, the reveal between the vertical glass edge of the door and the Latch Jamb is a maximum of 3/16" for the handle catch to work properly. A 1/8" is ideal. Please refer to FIGURE #3, for adjustment detail. From the inside of the shower, drill through the factory holes in the Latch Jamb, into the Jamb Filler using a #32 wire gauge drill bit. Secure the Latch Jamb with three #8 X 1/2" PHPHMS (ITEM #16)

AS-280: Procedure is the same.

STEP 9 - HANDLE ASSEMBLY:

Take the Inside Handle assembly, (the one with the bullet catch and adjustment screw), and insert two #6-32 X 1 1/2" FHPHMS, into the two screw holes in the Handle. Slide one Plastic Grommet over each threaded portion of each screw. WARNING: This shower door should not be installed without grommets. The grommets prevent the glass from touching the metal screw. If the metal touches the glass, the glass can break and create a serious safety hazard. With the door in the open position, from the inside of the door, insert the Handle assembly through the corresponding holes in the glass panel. Holding the assembly in place, set the Outside Handle assembly in place over the holes and tighten the screws. Adjust the catch mechanism as necessary by turning the Phillips head screw on the inside Handle assembly. Finish the installation by adjusting the Drip Deflector as follows: Close the door and from either the inside or the outside, use a block of wood to tap the deflector down so that the Door sweep is approximately 1/16" above the Curb Filler's horizontal surface. The deflector does not need to be tilted to function. Refer to FIGURE #2.

STEP 10 - HEADER FILLER:

Measure between the Hinge Jamb and Latch Jamb at the header, then cut the Header Filler (ITEM #3), to this dimension. Notch ends both to fit. Refer to FIGURE #7.

STEP 11 - CAULKING:

First, seal each end of the Drip Deflector with caulk, then run a bead of caulking the full length on the inside of the shower where each Jam Filler meets the wall and across the bottom where it meets the shower base.

Installation Instructions for the Accent/Euro Collection Swing Door With In-line Panel.

Model: ASD-180/280 & USD-180 /280 Rev. Date: 04-06-06

Drawing #: 6141



6141 - ASD & USD 180/280 Assembly Step-Up Instructions

STEP 1 – MEASURE

Measure between wall and step up, subtract 1/16" and cut Stall Curb (#2) to length. Set in place on threshold.

Figure A:

Cut Curb Filler (#3) to same length as Stall Curb and snap into place. Hold Stall Curb in place with strips of masking tape.

Figure B:

Insert Setting Block (#10) into Stall Curb to support Side-lite panel.

STEP 2 - ATTACH JAMB FILLER

Figure A:

Attach Jamb Filler (#8) to 180° Post, (#5), with 3- #10-24 x 9/16" PHPHMS, (#15). NOTE: These jambs will not be flush at the top. Set attached jambs in place and plumb with a level. Set Panel Sill in place lined up off of attached post. Hold in place with strips of masking tape. Remove attached post.

Figure B:

Set Vertical Panel Sill in place on stall curb, plumb and secure to buttress face. Next, set Horizontal Panel Sill in place and secure. Seal end of Panel Sill at wall with caulking.

STEP 3 - WALL CHANNEL

Figure A & B:

Set Wall Channel in place on top of Panel Sill, plumb and secure to wall. Insert Setting Blocks and install Side-lite panel.

STEP 4 - RE-INSTALL

Figure A:

Re-install post and secure to buttress face.

Figure B:

Install 180° post. Temporarily hold in place over panel edge with masking tape.

Figure A & B:

Measure wall to wall at top of posts, subtract 1/16" and cut Header to length. Install header over 180° Post and wall channel. Secure Header with 2- #6 x 3/8" PHPHMS from the inside of shower. Glaze Side-lite panel.

STEPS 6 - 11

To finish Installation. Follow steps 6 - 11 on page 5 and 6 of the 6141 Installation Instruction.

