

Installation Instructions for SSD 1/4" Semi-Frameless Door

FIRST STEPS - Identify the model number of your unit.

- Look on the white shipping label on the outer cardboard box.
- **Model number** on label should correspond to one listed above.

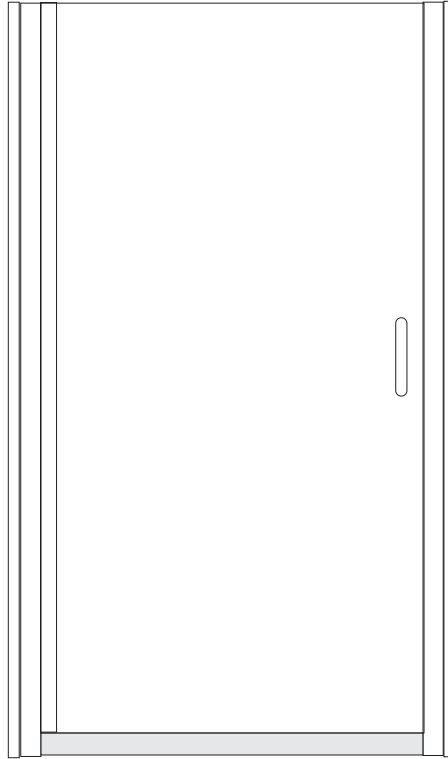

NOTE:

- Installation procedures are the same for tub or shower height units
- The images in this manual show an arrangement with the showerhead to the left. The same instructions apply for the opposite orientation where the examples would be reversed.

Required Tools

* Pencil or water soluble felt pen

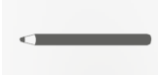

* Hacksaw with 24 tooth blade

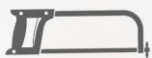

* Metal file (smooth sharp edges)

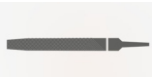

* Tape measure



* Clear 100% Silicone (recommended)



* #2 Phillips Screw driver



* 1/8", 3/16", 1/4", 3/8" drill bits (carbide for tile)



* Caulking gun



* Drill, electric or battery



* 4 ft. Level



* Rubber mallet

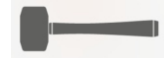

* Razor knife



P/N MM.5030
rev061920

READ ENTIRE MANUAL BEFORE INSTALLATION AND OPERATION

Warnings and General Shower Door Information



**SAFETY
WARNINGS:**



READ AND FOLLOW INSTRUCTIONS: Failure to follow all instructions, warnings and guidelines may result in serious injury or death, may cause water damage, and will void the terms of your warranty.

General Safety and Installation Policies

Before Installation:

- **Proper Size:** Ensure the enclosure is the proper size for your opening prior to beginning installation.
- **Safe Installation:** Some units may require two or more people to safely install the enclosure properly.
- **Packaging:** It is recommended to retain all packaging and other materials until installation is complete in the event of a return.
- **Inspect:** Installer should inventory all parts or components and inspect them for damage prior to beginning installation.
- **Sharp Edges:** Exposed ends of aluminum and other hard components can be rough, sharp or jagged due to the processes of cutting, drilling, notching, etc. Sharp ends must be deburred, smoothed or rounded by the installer before installation.
- **Safety equipment and tools:** Have all necessary safety equipment (glasses and gloves) and proper tools for the installation. The installer is responsible for determining the correct drill bit(s) for the installation.
- **New Tile:** We recommend that you allow at least 2 days (48 hours) for the tile cement and grout to dry before installing enclosure.

During Installation



- **Proper backing:** Shower doors are heavy. Therefore, glazing channels, fillers, hinges and headers blocks (structural components) should be secured to studs or solid backing beneath the tile or decorative substrate. Fasteners should screw directly into the backing. Wall anchors are provided primarily to separate screws from tile to reduce the possibility of cracking.

- **Tempered glass:** Glass can break. Shower door panels are tempered to ASTM C1048 specifications as required by building codes. Glass is tempered to greatly increase its strength and to make it fragment into smaller and lighter pieces reducing the possibility of injury in the event that the glass does break. Tempered glass will break and may cause bodily injury if you attempt to cut, drill, mill or alter it in any way. Care must be taken when handling tempered glass. Pay special attention to protect all edges of the glass from contact with hard surfaces.
- **Horizontal surfaces and installation holes:** Avoid drilling into the horizontal surfaces of tubs or showers unless it is required for the structural integrity of the unit. If you drill into horizontal surfaces, always generously caulk the holes, anchors, screws and on top of the screw head. If this is not done, or is done improperly, water damage can occur under the tile or substrate.
- **Weep holes in horizontal channels:** Drilling 3/8" weep holes on the inside of horizontal channels is recommended to allow any moisture build-up inside a channel to exit the channel. Due to varying installation conditions and installer's/owner's personal preference, however, we do not drill them in the factory.
- **Sliding and swinging glass doors:** A door may be improperly installed if it hits or scrapes against bathroom obstructions (toilets or cabinets) or any metal or glass components of the shower door itself. This could lead to glass breakage or serious injury. The installer must correct the deficiencies before allowing the door to be used.
- **Surface conditions:** Most shower door designs allow for out-of-square or unlevel installation. Generally, any outage more than 3/8" that was not identified during the ordering process is outside of these allowances and can result in an improper installation.

Caulking/Siliconing the Unit:

- Always clean all contact surfaces before caulking and use a high grade 100% silicone for best results.
- After installation, at a minimum, caulk the entire outside perimeter of the unit where the unit touches walls, sills, and step-ups, etc. Also caulk any vertical joints between metal components where water build-up inside of the channels could leak out.

After Installation:

- **Curing times:** Adhere to manufacturers' recommended curing times for VHB tapes, silicones and any other adhesives, coatings or chemicals used during installation. Unless otherwise stated, it is recommended to wait 72 hours before using the enclosure.
- **Normal wear and tear:** Although these enclosures are designed to last for years, certain items (such as the polycarbonate seals and door sweeps) may need to be replaced as they show signs of aging and wear.

General Disclaimers

- **Shower Doors are not watertight:** Consumers should understand that a shower door is not watertight. The amount of water that can escape your shower can vary greatly based on shower/tub size, configuration of shower head(s), type of thresholds and drains and by the type of shower door itself. Heavy glass units with no or limited vinyl seals, for example, can allow water to escape under normal conditions. Doors with more metal and seals generally provide more water protection. Excessive water pressure or directing shower heads or hand held sprays directly at doors or joints is not a normal shower conditions and can result in leaks.
- **Towel bars, handles and accessories** are in no way considered to be grab bars or other bracing or fall prevention mechanisms. The intent of these accessories is to facilitate proper operation or enhance the esthetics and functionality of the unit.

Owners Manual:

Refer to your Owners Manual for general installation and cleaning and care instructions. If a copy of the Owners Manual was not included, you can download one on the RESOURCES page of our website.

Questions or Comments:

1-800-843-3332

Installation Instructions

Models: SSD - Silhouette Swing Door

1/4" Semi-Frameless Door



P/N MM.5030 061920

This installation sheet is a component added during boxing of unit or KD.

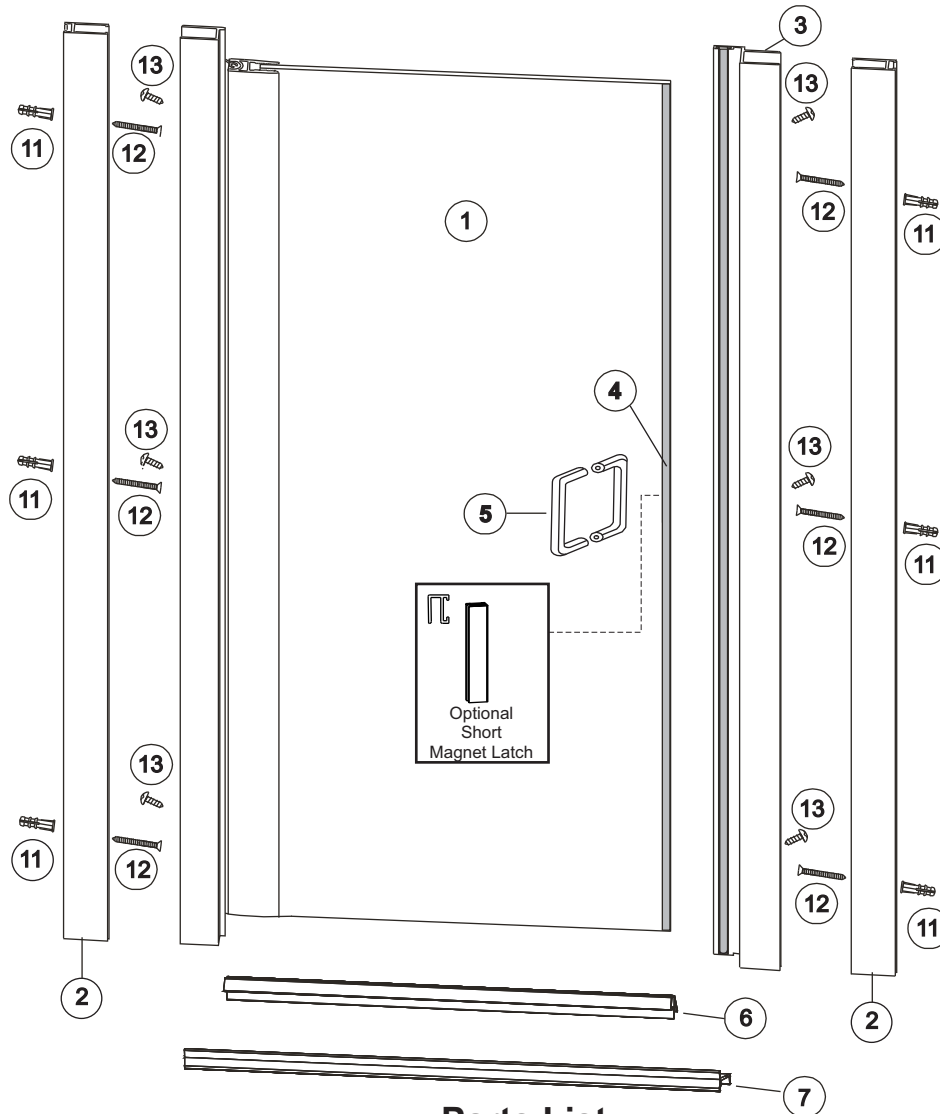

Parts List

	LATCH PACK	CAT#:	PART LIST	QTY.:		PART LIST:	QTY.:
		①	DOOR ASSEMBLY	1			①① BP.3027 3/16" WALL ANCHORS 6
		②	1268 WALL CHANNEL	2			①② BP.3027 #8 X 1-1/2" FHPHMS 6
		③	1193 STRIKE JAMB w/ VN.4100 Magnet	1			①③ BP.3027 #8 X 1/2" PH TEK SCREWS 6
		④	VN.4102 MAGNET w/ VHB TAPE	1			①④ Optional Short Magnet Latch 1
		⑤	HA.2701 D-PULL HANDLE ASSEMBLY	1			①④ Optional Bulb seal latch vinyl 1
		⑥	BP.4062 DRIP RAIL	1			
		⑦	1019 DAM STRIP	1			

1 Mark the centerline of the opening lightly with a pencil. Evaluate your threshold. If an inward slope is not present on your threshold use the dam strip. If using the dam strip, measure from wall to wall and cut it to 1/16" less than the opening. Install the dam strip with the vertical lip to the outside. Before mounting the wall jambs for a door only installation, cut the wall channels down to the same size as the hinge and strike. Position the wall jambs down onto the dam strip or threshold, over the centerline, then plumb and mark hole locations. Drill 3/16" holes and install the anchors. Place wall channels over the anchors and secure with #8x1-1/2" screws. Check for plumb and adjust if

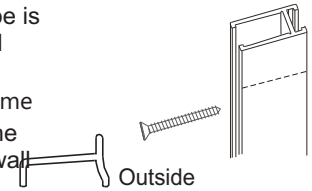

2 Determine which side you would prefer the door to hinge from, usually the side with the shower head. Place the strike jamb over the wall channel opposite the side where the door will hinge. Position the hinge jamb over the remaining wall channel and secure the at the top with a clamp or #8x1/2" tek screw. Plumb with a level, and adjust the hinge and strike jambs to leave a 3/16" reveal between the edge of the door and the base of the strike jamb from top to bottom. Once the door is plumb and level, secure the middle and bottom of the hinge jamb with a #8x1/2" tek screw. Attach the handle through the holes in the glass using the provided shims and bushings.



3 Before installing the full length magnet, clean the door glass. Please note the polarity of the magnet in the latch jamb and magnet with the adhesive. Apply the magnet to the glass by peeling off the backing and applying it down the edge of the glass as shown. Adjust the strike to work correctly with the magnet in the rail and to be plumb. If the magnets repel each other, reverse the magnet strip in the latch jamb. Secure the top, middle and bottom of the strike with #8x1/2" tek screws. If you have the short magnetic latch option, refer to the bottom of this page for instructions.

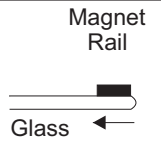

4 Measure the bottom of the door from the edge of the glass to the hinge rail. Cut the drip rail to that size so that the notch is on the side where the hinge rail is and the flange is on the inside of the shower. Notch the flange of the drip rail so that it does not interfere with the strike on the inside of the door. The flange may be scored with a razor knife to make it easier to snap off. The upper portion of the drip rail should be notched so that the flexible sweep extends under the hinge rail. When you are satisfied with the fit of the drip rail install it onto the bottom of the door pushing up far enough so that the sweep drags across the dam strip. When the rest of the installation is complete, remove the drip rail and place a few drops of silicone into the channel.

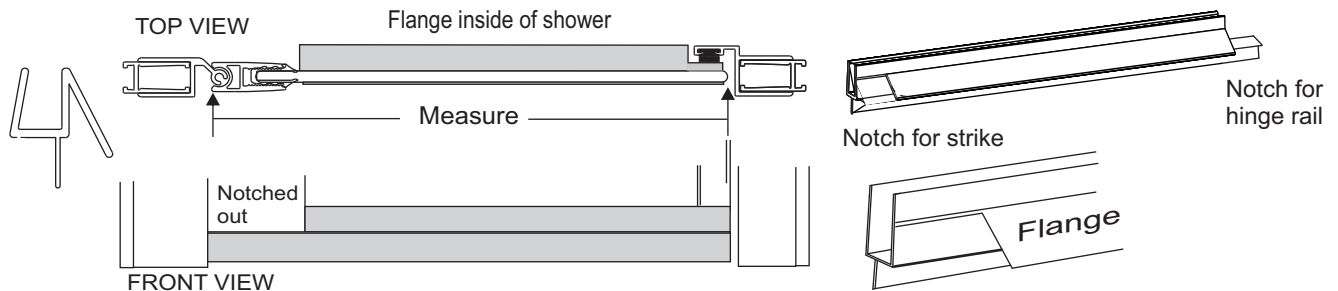

Disassemble the handle assembly, noting where the plastic washers are located. From the inside of the door, insert the screw lugs through the glass and into the front handle and tighten. Loosen the set screws and install the inside handle over the screw lugs and tighten the set screws.

5 We recommend filing any sharp corners that may cause injuries, then clean and run a continuous bead of silicone sealant outside of the threshold and up the wall jambs.

Alignment of Magnetis Latch

- Clean the door glass before installing the magnet rail
- Locate the steel plate on the latch jamb. The magnetic latch will line up with the plate
- Mark on the door glass where the magnetic latch lines up with the plate

For 1/4" glass, Place a small bead of silicone into the magnet latch

- Place the rail on the edge of the glass with the magnet toward the inside and push the magnet rail carefully onto the glass until it is seated
- Clean off any silicone
- Secure the magnet rail with masking tape or blue painters tape for 24 hours until the silicone is cured

